

## LOCATION MAP

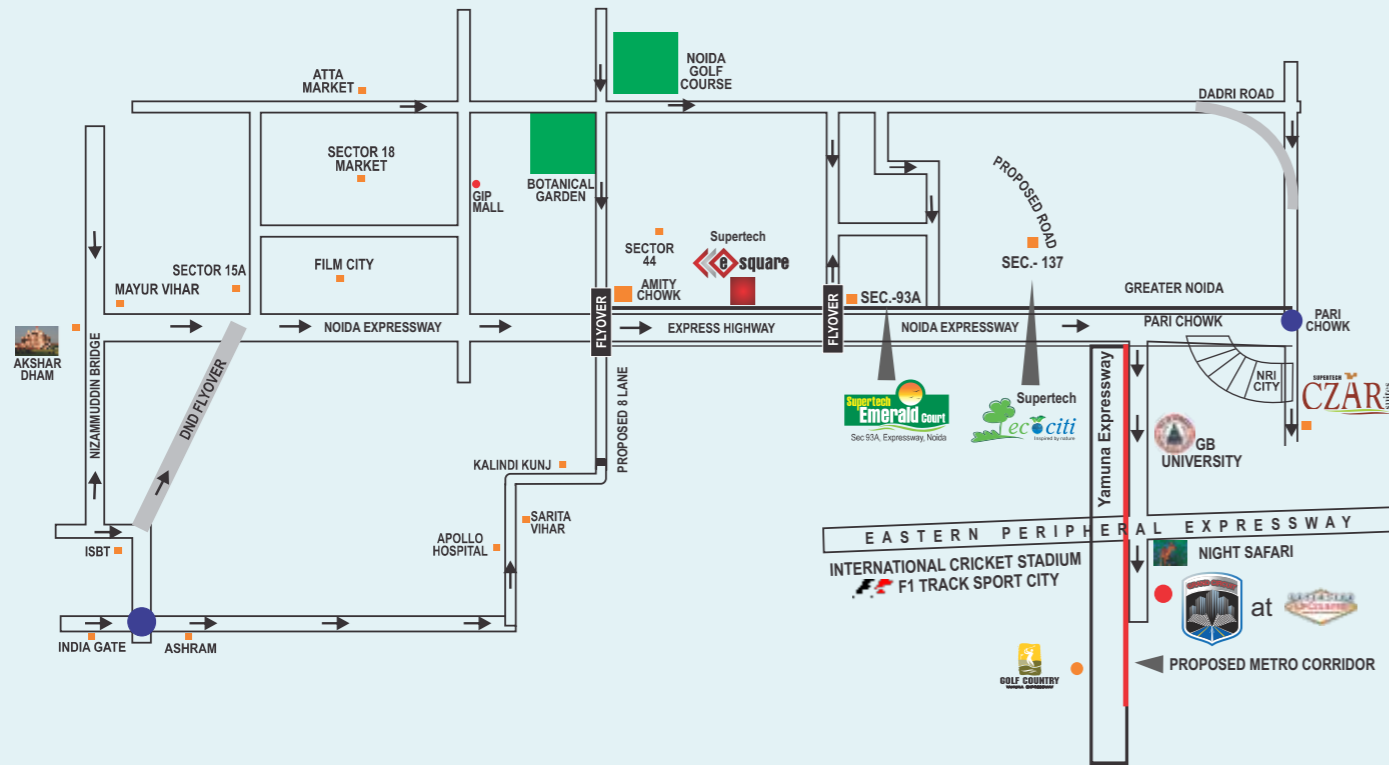

- Located on main Yamuna Expressway
- Close to motor racing track, proposed international airport, Night Safari, Golf Course
- Proposed metro connectivity

### Supertech. Yours for life.

With a legacy of over 25 years, Supertech is constantly changing the face of Indian real estate industry. Supertech today, stands tall in the real estate market with several landmark projects up its sleeves. The core reason being its unwavering commitment towards adopting state-of-the-art engineering techniques, innovative designs and timely delivery of the projects on the way to realizing its customers' dreams.

Supertech is recognized as a reliable and dynamic partner, thanks to its uncompromising attitude towards quality, consistency and a dedication to create architectural landmarks at par with the International best. After building several landmarks in the NCR region, the company has now expanded its footprints to other cities as well. It's this incessant effort to create value through excellence that has earned several accolades for Supertech including the coveted 'Udyog Ratan Award' and the 'Business Excellency Award'.

### Milestones:

- More than 12,000 residential units delivered
- Projects across 38 locations
- More than 60,000 satisfied customers
- Over 25 years of delivering world class projects in Residential, Retail, Hospitality IT Parks, Education and Corporate Spaces
- Projects worth INR 180 billion in progress
- Over 90 million square feet of real estate under development
- Delivery target of 10,000 units across different projects for year 2014
- Total number of Units under construction are 60,000



**Call:** 7838787866 & 7838787858 | **sms** STC to 56677 | **website:** www.supetechlimited.com  
**Site Address:** Plot No. TS-01, Sector-17A, Yamuna Expressway, Greater Noida  
**Supertech Limited:** Supertech House- B 28-29, Sector 58, Noida 201307. Ph.: 0120- 4572600



GRAND CIRCUIT  
1/2/3 BHK Apartments



THE WORLD TRAVELS THOUSANDS OF MILES  
TO WATCH MOTOR RACING.

FEW LUCKY ONES, WATCH IT LIVE FROM THEIR BALCONIES.





## GRAND CIRCUIT

PREMIUM RESIDENTIAL APARTMENTS  
ON YAMUNA EXPRESSWAY

Nothing could be more exciting than living next to a destination that commands speed. That's why, Supertech brings you 1/2/3 BHK luxurious residences right next to the 5.14 km long Motor Racing Track in Greater Noida. Nestling amidst lush green surroundings at a stone's throw from major places of interest, this upcoming cradle of thrill is surely going to evolve as the most sought-after abode in times to come.

### Features to set your pulse racing:

- Overlooks the 5.14 km long Motor Racing Track
- Part of Supertech Upcountry, 100 acre grand civilization on Yamuna Expressway
- Premium residences with wide choice of spaces
- World-class amenities and recreational facilities like man-made beach and lakes, lush green landscaping, luxury club house and much more.
- Education, medical, sports, hospitality facilities and corporate offices within the township
- 9-hole well designed golf course in the vicinity
- Close to FNG (Faridabad-Noida-Gurgaon) corridor, proposed international airport and metro connectivity.



# FLOOR PLAN

FLOOR PLAN: 1 BHK  
SUPER AREA: 625 SQ.FT



# FLOOR PLAN

FLOOR PLAN: 2 BHK + STUDY  
SUPER AREA: 1155 SQ.FT



FLOOR PLAN: 2 BHK  
SUPER AREA: 900 SQ.FT



FLOOR PLAN: 3 BHK + 2 TOILET  
SUPER AREA: 1295 SQ.FT



AREA STATEMENT		4,07,946.84 SQ.M.
TOTAL PLOT		
PLOTTED DEVELOPMENT		
i.	100 SQ. YD PLOTS SIZE = 6.465 MT. X 12.935 MT.	380 No.s
ii.	150 SQ. YD PLOTS SIZE = 7.91 MT. X 15.855 MT.	124 No.s
iii.	200 SQ. YD PLOTS SIZE = 9.140 MT. X 18.365 MT.	132 No.s
VILLA DEVELOPMENT DETAIL		
i.	90 SQ. YD VILLA (TYPE-S1) SIZE = 6.00 MT. X 12.645 MT.	133 No.s VILLA
ii.	125 SQ. YD VILLA (TYPE-S6) SIZE = 7.08 MT. X 14.762 MT.	124 No.s VILLA
iii.	200 SQ. YD VILLA (TYPE-S3) SIZE = 9.140 MT. X 18.285 MT.	37 No.s PLOT/VILLA
iv.	500 SQ. YD VILLA (TYPE-S4) SIZE = 14.455 MT. X 28.920 MT.	18 No.s PLOT/VILLA
HOUSING TOWERS DETAIL		
1.	500 sq. ft. Studio	
2.	625 sq. ft. 1 BHK	
3.	900 sq. ft. 2 BHK	
4.	1155 sq. ft. 2 BHK + Study	
5.	1295 sq. ft. 3 BHK + 2 TOI	

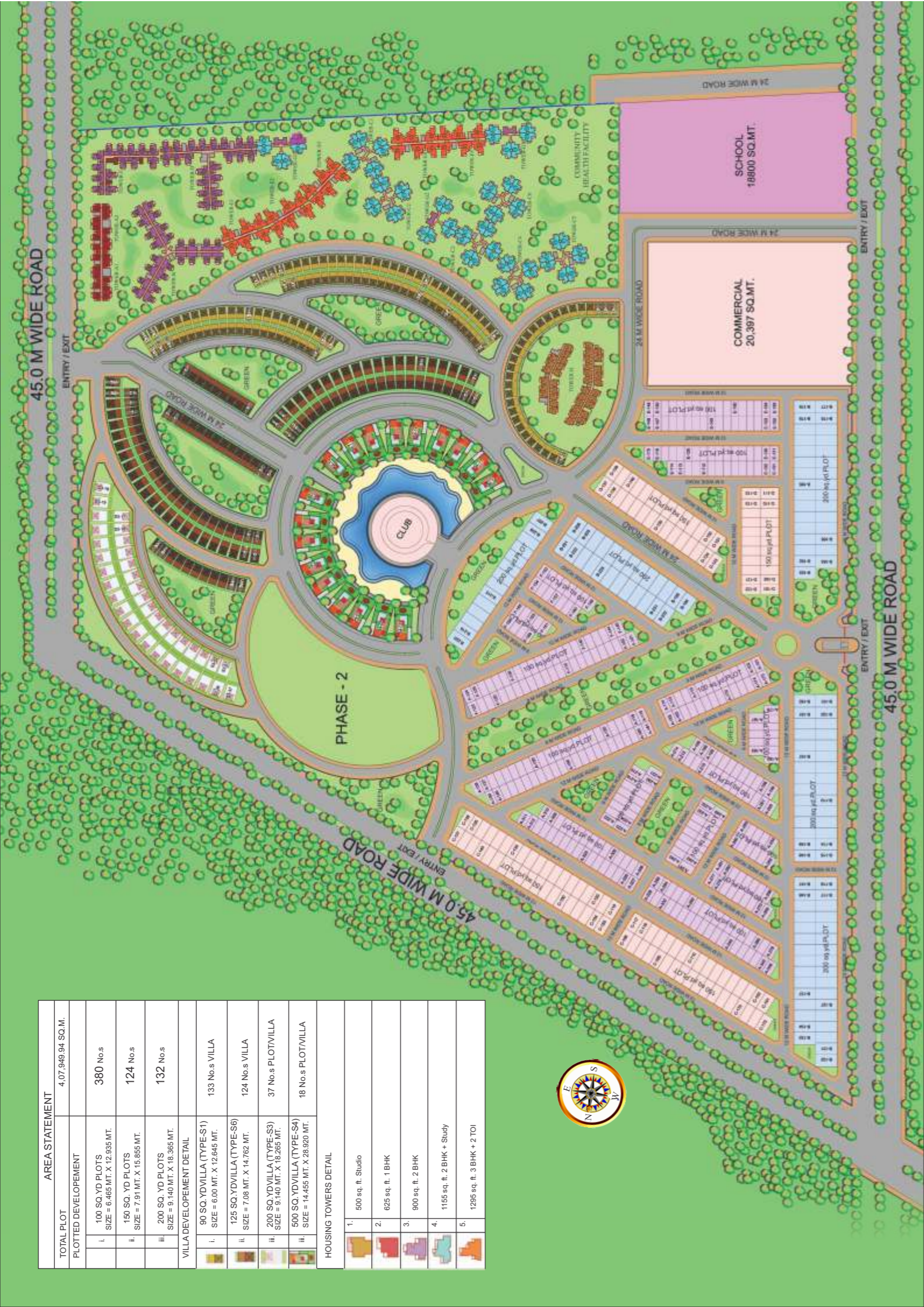

## SPECIFICATIONS

LOCATION	FLOOR	EXTERNAL DOOR AND WINDOW	ELECTRICAL FITTINGS	WALLS	FITTINGS	INTERNAL DOOR	HARDWARE	ELECTRICAL	WATER SUPPLY	CEILINGS
DINING	Vitrified Tiles	Powder Coated Aluminium with Double Rebate	Sheet and Switches	Oil Bound Distemper	-	Flush Shutter with Wooden Frame	All doors and windows with metal fittings along with mortice lock on the main door	Copper wiring and PVC concealed conduit. Provision for adequate light and power points as well as Television and T.V. outlets with modular switches and protective M.C.B.'s	Underground and overhead water tanks with pumps and 24 hours water supply. Individual R.O. plant of standard make in each kitchen.	Oil Bound Distemper
BEDROOM	Vitrified Tiles	Powder Coated Aluminium with Double Rebate	Sheet and Switches	Oil Bound Distemper	-	Flush Shutter with Wooden Frame				Oil Bound Distemper
KITCHEN	Vitrified Tiles	Powder Coated Aluminium with Double Rebate	Sheet and Switches	Ceramic Tiles of 2' height from the platform	Stainless Steel Sink with C.P. Fittings	Open				Oil Bound Distemper
TOILET	Ceramic Tiles	-	Sheet and Switches	Ceramic Tiles of 7' height	Washbasin WC & C.P. Fittings	Flush Shutter				False Ceiling Permanent Paint Finish
BALCONIES	Ceramic Tiles	-	Sheet and Switches	Oil Bound Distemper	-	-				-
LIFT	P.V.C. Flooring	-	Sheet and Switches	-	-	-				-
LOBBIES/CORRIDOR	Kota Stone / Vitrified Tiles	-	-	Oil Bound Distemper	-	-				-
EXTERIOR FINISH	-	-	-	Texture Paint	-	Flush Shutter with Wooden Frame				-