



An ISO 9001:2008 Company

Developing India

**AMRAPALI  
GROUP**



*2,3,4 Bedroom Apartments & Penthouses  
Sector-76, Noida*



*Floor Plans*

# The Site

SECTOR - 77

- 2 BHK + 2 TOILET
- 2 BHK + 2 TOILET + STUDY
- 3 BHK + 2 TOILET
- 3 BHK + 2 TOILET - A
- 3 BHK + 3 TOILET + STUDY
- 3 BHK + 2 TOILET - C
- 3 BHK + 2 TOILET - B
- 4 BHK + 4 TOILET + SERVANT



FUTURE USE

**Amrapali**

**Siicon City**

Amrapali - Sector-76, Hehal

**Phase - 1**

SECTOR - 78

*Two* Bedroom + 2 Toilet

Super Area : 875 sq. ft.  
 Tower - R & S

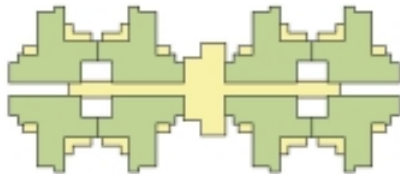

*Two* Bedroom + 2 Toilet + Study

Super Area : 1015 sq. ft.  
 Tower - A,B,C,D,E,F,G,H,J,K,L,M,N

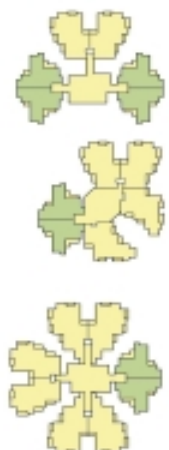

*Two* Bedroom + 2 Toilet + Study

Super Area : 1090 sq. ft.

Tower - O & P



# Three Bedroom + 2 Toilet

Super Area : 1315 sq. ft.

Tower - L

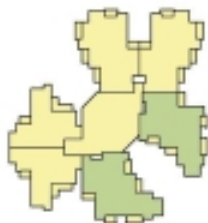

# Three Bedroom + 2 Toilet (A)

Super Area : 1315 sq. ft.  
 Tower - A,B,C,D,E,F,G,H,J,K,L



# Three Bedroom + 2 Toilet

Super Area : 1415 sq. ft.

Tower - P



# Three Bedroom + 3 Toilet + Study

Super Area : 1455 sq. ft.  
 Tower - A,C,D,E,F,G,H,K,M,N

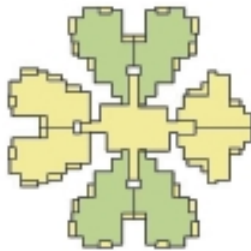



# Three Bedroom + 3 Toilet + Study

Super Area : 1540 sq. ft.

Tower - O



*One* Bedroom + 1 Toilet

Super Area : 675 sq. ft.  
 Tower - B

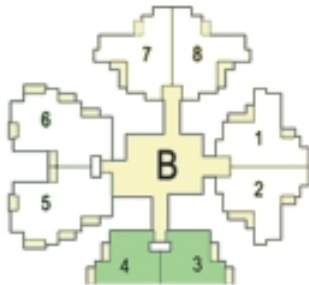

Ground Floor Plan



*One* Bedroom + 1 Toilet

Super Area : 720 sq. ft.  
 Tower - A



Ground Floor Plan



\* All above features and layout are tentative and subject to change without any prior notice. These are purely conceptual and constitute no legal offerings.

*Two* Bedroom + 2 Toilet

Super Area : 915 sq. ft.

Tower - R, S

Ground Floor Plan

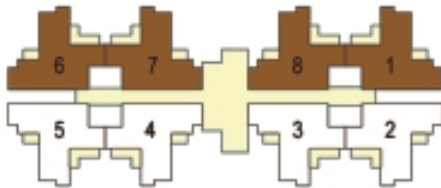

\* All above features and layout are tentative and subject to change without any prior notice. These are purely conceptual and constitute no legal offerings.

*Two* Bedroom + 2 Toilet + Study  
 Super Area : 1090 sq. ft.  
 Tower - A,B,C,D,E,F,G,H,J,K,L,M,N,O,P

## Ground Floor Plan



*Three* Bedroom + 2 Toilet

Super Area : 1415 sq. ft.

Tower - L

Ground Floor Plan



# Three Bedroom + 2 Toilet

Super Area : 1415 A sq. ft.

Tower - E,F,G,J,K

## Ground Floor Plan



# Three Bedroom + 3 Toilet + Study

Super Area : 1540 sq. ft.  
 Tower - A,C,D,E,F,H,K

## Ground Floor Plan

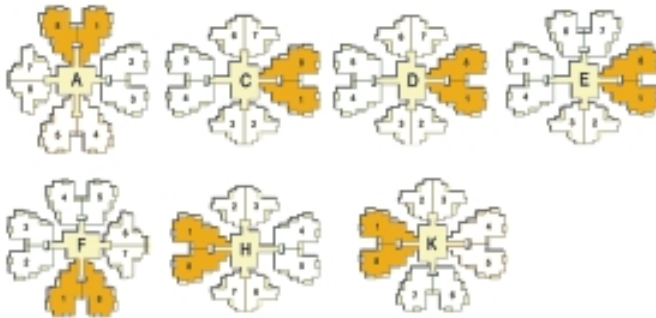

# The Location



**AMRAPALI GROUP**

Corporate Office : C-56/40, Sector-62, Noida. Phone : 0120-4055555 | Fax : 0120-4233556  
 E-mail : [mkt@amrapali.in](mailto:mkt@amrapali.in) | Website : [www.amrapali.in](http://www.amrapali.in) | SMS 'Amrapali' to 56677

APARTMENTS • MALLS & MULTIPLEXES • SEZs • IT PARKS • HOTELS • HOSPITALS • EDUCATION • FMCG (Mum's)